

STORM SEWER TABLE

US MH Ref.	US MH CL [mod]	US MH IL [mod]	DS MH IL [mod]	Length [m]	Gradient [1 in...]	Pipe Diameter [mm]	Cover to US Soffit [m]	Notes
S1.0	S1.1	57.100	56.324	56.300	6	250	0.551	** AJ
S1.1	S1.2	57.000	56.300	56.256	11	250	0.475	** AJ
S1.2	S1.3	56.850	56.256	56.212	11	250	0.369	** AJ
S1.3	Attn	57.300	56.212	56.200	3	250	0.863	** IC
Attn	S1.4	57.600	56.200	56.196	1	250	1.175	** MH
S1.4	S1.5	57.600	56.196	56.120	19	250	2.25	** MH

** DENOTES PIPE RUNS WHICH REQUIRE CONCRETE PROTECTION, BD DENOTES BACKDROP MANHOLE, AJ DENOTES ARMSTRONG JUNCTION, IC DENOTES INSPECTION CHAMBER, MH DENOTES MANHOLE

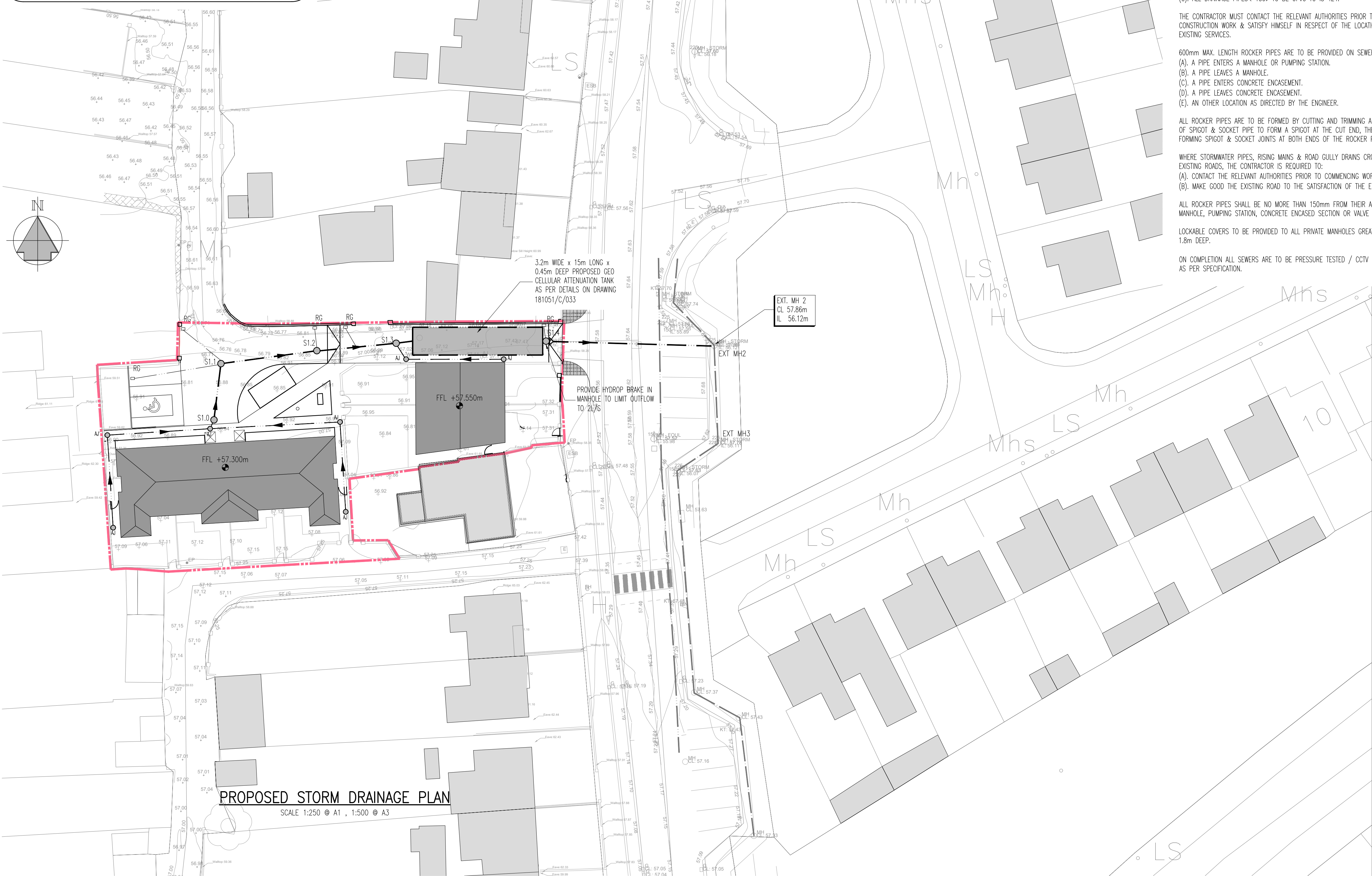

PROPOSED STORM DRAINAGE PLAN
SCALE 1:250 @ A1, 1:500 @ A3

SURFACE WATER DRAINAGE:-

ALL ROAD GULLY / ACCESS JUNCTION PIPE RUNS TO BE 150mm Ø UPVC @ 1 : 50 GRADIENT UNLESS NOTED OTHERWISE.
ALL RWP'S TO CONNECT TO MAINS SEWER WITH 100mm Ø UPVC PIPE @ 1 : 80, USING LONG RADIUS BEND TO CROWN OF PIPE.
ALL ROAD GULLY & RWP DRAINS ARE TO HAVE 100mm CLASS 15/20 CONCRETE SURROUND.

PUBLIC SEWERS AND MANHOLES SHOULD COMPLY WITH REQUIREMENTS OF THE GREATER DUBLIN STRATEGIC DRAINAGE STUDY AND THE LOCAL AUTHORITY CODE OF PRACTICE FOR DRAINAGE WORKS AND STANDARD DETAILS.

ALL ROAD GULLIES TO BE TRAPPED AND COMPLY WITH NRA SPECIFICATION FOR ROAD WORKS.

PRIVATE DRAINAGE RUNS:
(A). ALL DRAINAGE PIPES 375Ø TO BE CLASS 'H' SPIGOT & SOCKET CONCRETE PIPES TO I.S. 6 UNLESS OTHERWISE NOTED.
(B). ALL DRAINAGE PIPES > 225Ø TO BE CLASS 'M' SPIGOT & SOCKET CONCRETE PIPES, UNLESS OTHERWISE NOTED.
(C). ALL DRAINAGE PIPES < 150Ø TO BE UPVC TO IS 424.

THE CONTRACTOR MUST CONTACT THE RELEVANT AUTHORITIES PRIOR TO CONSTRUCTION WORK & SATISFY HIMSELF IN RESPECT OF THE LOCATION OF ALL EXISTING SERVICES.

600mm MAX. LENGTH ROCKER PIPES ARE TO BE PROVIDED ON SEWERS WHERE:
(A). A PIPE ENTERS A MANHOLE OR PUMPING STATION.
(B). A PIPE LEAVES A MANHOLE.
(C). A PIPE ENTERS CONCRETE ENCASEMENT.
(D). A PIPE LEAVES CONCRETE ENCASEMENT.
(E). AN OTHER LOCATION AS DIRECTED BY THE ENGINEER.

ALL ROCKER PIPES ARE TO BE FORMED BY CUTTING AND TRIMMING A LENGTH OF SPIGOT & SOCKET PIPE TO FORM A SPIGOT AT THE CUT END, THEREBY FORMING SPIGOT & SOCKET JOINTS AT BOTH ENDS OF THE ROCKER PIPE.

WHERE STORMWATER PIPES, RISING MAINS & ROAD GULLY DRAINS CROSS EXISTING ROADS, THE CONTRACTOR IS REQUIRED TO:
(A). CONTACT THE RELEVANT AUTHORITIES PRIOR TO COMMENCING WORK.
(B). MAKE GOOD THE EXISTING ROAD TO THE SATISFACTION OF THE ENGINEER.

ALL ROCKER PIPES SHALL BE NO MORE THAN 150mm FROM THEIR ASSOCIATED MANHOLE, PUMPING STATION, CONCRETE ENCASED SECTION OR VALVE CHAMBER.

LOCKABLE COVERS TO BE PROVIDED TO ALL PRIVATE MANHOLES GREATER THAN 1.8m DEEP.

ON COMPLETION ALL SEWERS ARE TO BE PRESSURE TESTED / CCTV SURVEYED AS PER SPECIFICATION.

GENERAL NOTES:-

- THIS DRAWING TO BE READ IN CONJUNCTION WITH ALL RELEVANT ARCHITECTS & ENGINEERS DRAWINGS & SPECIFICATIONS.
- DO NOT SCALE. USE FIGURED DIMENSIONS ONLY.
- THE CONTRACTOR SHALL VERIFY ALL DIMENSIONS & ELEVATIONS WITH ARCHITECTURAL DRAWINGS PRIOR TO START OF CONSTRUCTION. ALL DISCREPANCIES TO BE NOTIFIED, IN WRITING TO ENGINEERS & ARCHITECTS FOR RESOLUTION.
- ALL DIMENSIONS ON DRAWINGS ARE IN MILLIMETRES UNLESS OTHERWISE NOTED.
- FOR DETAILS AND SETTING OUT OF RWP, SVP, WVP & ALL OPENINGS SEE THE RELEVANT ARCHITECTS DRAWINGS.
- FOR RADON BARRIER, D.P.C. & INSULATION DETAILS REFER TO ARCHITECTS DRAWINGS

ABBREVIATIONS:-

BTM	BOTTOM
C/C	CENTRE TO CENTRE
CTRS	CENTRES
SFL	STRUCTURAL FLOOR LEVEL
FFL	FINISHED FLOOR LEVEL
TOC	TOP OF CONCRETE
TP	TOP
TOS	TOP OF STEEL
UNO	UNLESS NOTED OTHERWISE

DRAWING NOTES:-

- DENOTES SITE BOUNDARY
- DENOTES EXISTING BUILDING
- DENOTES PROPOSED BUILDING
- DENOTES EXISTING SITE LEVELS
- DENOTES FINISHED FLOOR LEVEL
- DENOTES PROPOSED GROUND LEVEL

STORM LEGEND:-

- EXT DENOTES EXISTING STORM SEWER FOR PL ROADS
- DENOTES EXISTING STORM SEWER RUN & MANHOLE TO BE GRUBBED UP
- AJ DENOTES PROPOSED STORM SEWER & AJ/INSPECTION CHAMBER/MANHOLE
- S1.2 DENOTES PROPOSED STORM SEWER & BACKDROP MANHOLE
- S1.2 DENOTES STORM SEWER LINE & HYDROBRAKE MANHOLE
- RG DENOTES PROPOSED STORM SEWER & ROAD GULLY

ALL SETTING OUT DIMENSIONS TO BE CHECKED AGAINST ARCHITECTS DRAWINGS. ARCHITECTS DRAWINGS TO TAKE PRECEDENCE.

Issue Register

No.	Date	Revision	Drawn	Checked	Approved
PL1	07/02/19	ISSUED FOR PLANNING	MT	LMJ	MJP

PLANNING ISSUE

Client: KILKENNY COUNTY COUNCIL

Project: PROPOSED DEVELOPMENT OF RESIDENTIAL UNITS AT GOLFLINKS ROAD

Drawing Title: PROPOSED STORM DRAINAGE PLAN

Project No: 181051 **Scale:** 1:250@A1

Drawing No: 181051-C-005 **Rev:** PL1

Drawn: MT **Checked:** LMJ **Date:** 07/01/19

Martin Peters Associates
Consulting Engineers
Ormonde Road
Kilkenny
T. +353 56 7702761
F. +353 56 7707278
E. info@mpa.ie