

Invert Culvert  
PVC Pipe  
24.31m

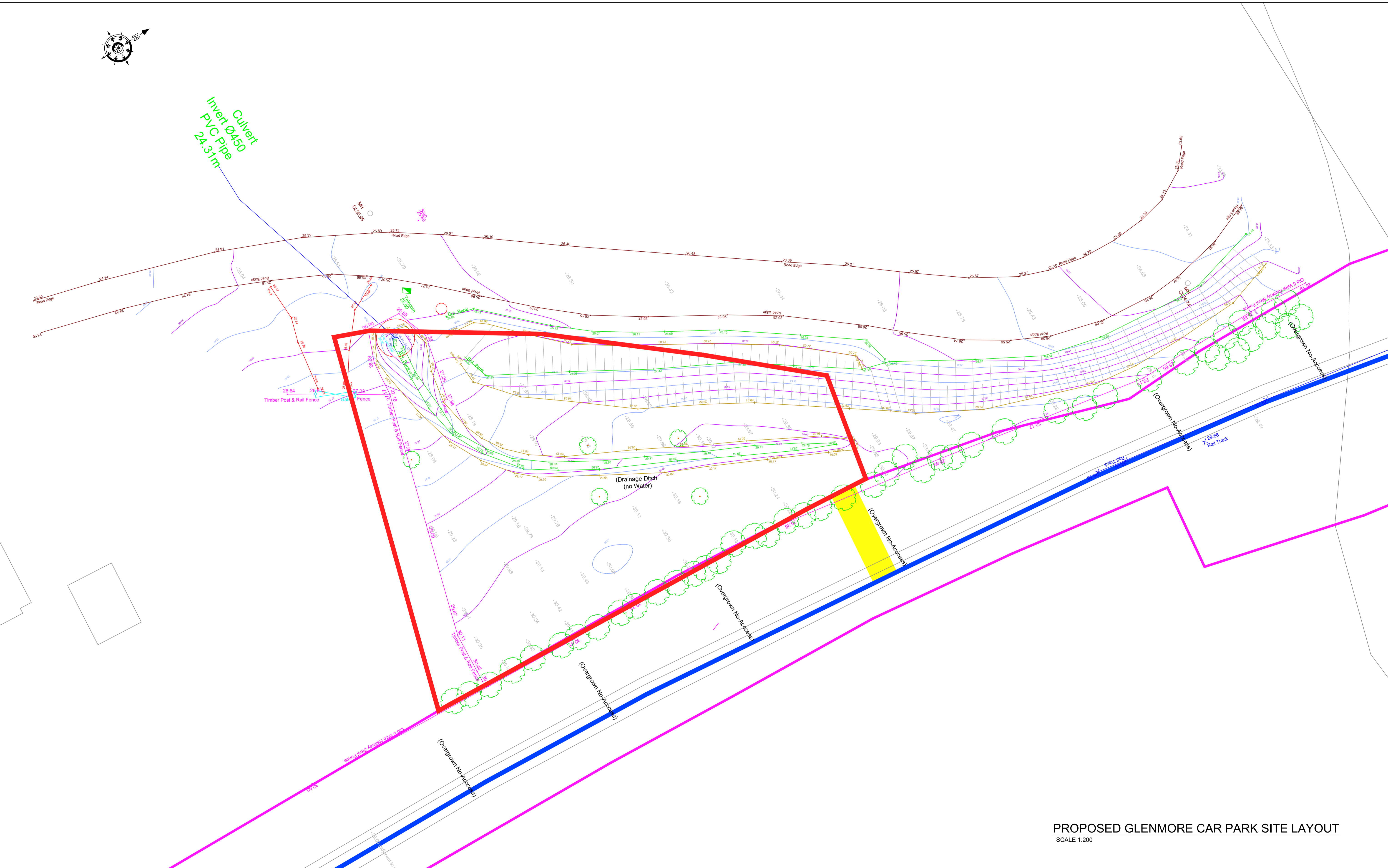

**PROPOSED GLENMORE CAR PARK SITE LAYOUT**  
SCALE 1:200

**NOTES:**

- DO NOT SCALE FROM THIS DRAWING. USE FIGURED DIMENSIONS IN ALL CASES.
- VERIFY DIMENSIONS ON SITE AND REPORT ANY DISCREPANCIES TO THE DESIGNERS IMMEDIATELY.
- THIS DRAWING TO BE READ IN CONJUNCTION WITH THE DESIGNERS SPECIFICATION.
- THIS DRAWING IS COPYRIGHT AND MAY ONLY BE REPRODUCED WITH THE DESIGNERS PERMISSION.
- ALL LEVELS ARE IN METERS RELATED ORDNANCE DATUM MALIN.
- ALL DIMENSIONS ARE IN METERS. UNLESS OTHERWISE STATED.
- REPRODUCED FROM THE ORDNANCE SURVEY BY PERMISSION OF THE GOVERNMENT. LICENCE No. EN 0015717.

**LEGEND:**

	Denotes Proposed Access to Greenway
	Denotes Existing Railway Line
	Denotes Proposed Greenway Boundary
	Denotes Proposed Car park Boundary



PROJECT:  
**SOUTH EAST GREENWAY**

TITLE:  
**PROPOSED GLENMORE CAR PARK & ACCESS TO THE GREENWAY SURVEY & SITE LAYOUT**

**Malachy Walsh and Partners**  
Engineering and Environmental Consultants  
Cork | Tralee | London | Limerick

Park House  
Mahon Technology Park  
Bessboro Road  
Blackrock  
Cork  
T12 X251  
Tel: +353 (0)21 4536400  
E-mail: cork@mwp.ie

REV/	DATE	DESCRIPTION	BY	APP
DATE:	MAR 2020	SCALE @ A1:	1:200	
PROJECT NUMBER:	19983	DRAWING STATUS:	S2	
DRAWING NUMBER:	WCC01-MWP-ZZ-01-DR-C-1521	REV:	P02	