

**PROPOSED SITE LIGHTING LAYOUT AT NEW ROSS BOAT YARD**  
SCALE 1:200

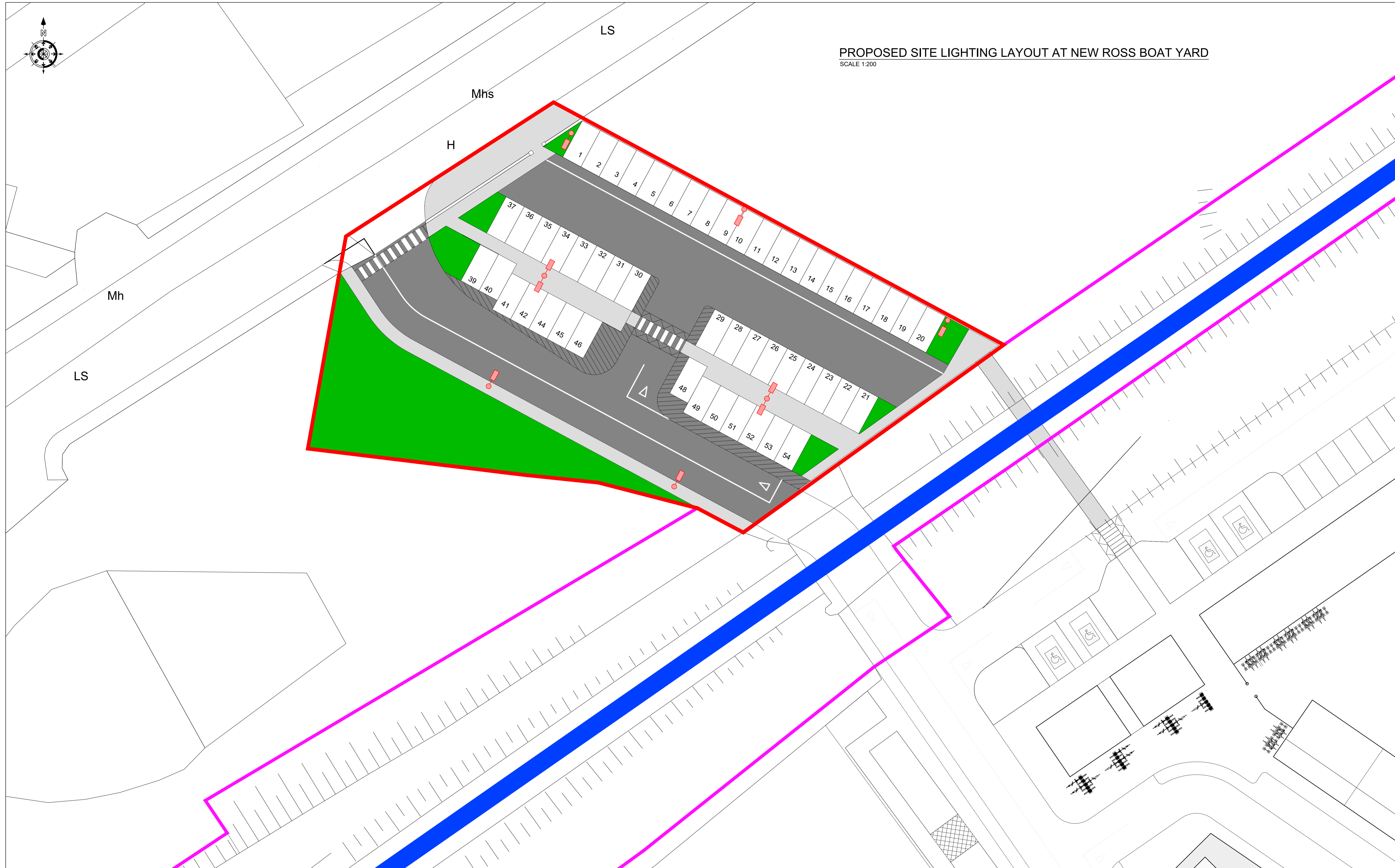

**NOTES:**

- DO NOT SCALE FROM THIS DRAWING. USE FIGURED DIMENSIONS IN ALL CASES.
- VERIFY DIMENSIONS ON SITE AND REPORT ANY DISCREPANCIES TO THE DESIGNERS IMMEDIATELY.
- THIS DRAWING TO BE READ IN CONJUNCTION WITH THE DESIGNERS SPECIFICATION.
- ALL LEVELS ARE IN METERS RELATED ORDNANCE DATUM MALIN.
- ALL DIMENSIONS ARE IN METERS, UNLESS OTHERWISE STATED.
- REPRODUCED FROM THE ORDNANCE SURVEY BY PERMISSION OF THE GOVERNMENT. LICENCE No. EN 0015717.

**LEGEND:**

- Denotes Existing Railway Line and Proposed Greenway Route
- Denotes Proposed Greenway Boundary
- Denotes Proposed Car park Boundary
- 5m High Steel Lighting Column



PROJECT: SOUTH EAST GREENWAY

TITLE: PROPOSED SITE LIGHTING LAYOUT AT NEW ROSS BOAT YARD

**Malachy Walsh and Partners**  
Engineering and Environmental Consultants

Cork | Tralee | London | Limerick

Park House  
Mahon Technology Park  
Bessboro Road  
Blackrock  
Cork  
T12 X251

Tel: +353 (0)21 4536400  
E-mail: cork@mwp.ie

|                 |                           |                        |       |     |
|-----------------|---------------------------|------------------------|-------|-----|
| REV             | DATE                      | DESCRIPTION            | BY    | APP |
| P02             | 23.07.20                  | ISSUED FOR INFORMATION | BK    | JOL |
| P01             | 08.04.20                  | ISSUED FOR INFORMATION | JL    | JOL |
| DATE            | MAR 2020                  | SCALE @ A1:            | 1:200 |     |
| PROJECT NUMBER: | 19983                     | DRAWING STATUS:        | S2    |     |
| DRAWING NUMBER: | WCC01-MWP-ZZ-01-DR-C-1534 | REV:                   | P02   |     |