

**Kilkenny County Council Compulsory Purchase Order**

Lands Proposed to be Compulsory Acquired by Kilkenny County Council shown highlighted in red

Former Garda Barracks, Castlecomer  
ELECTORIAL AREA: Castlecomer

Dwelling Area (shaded pink) = 447 sqm  
Right of Way (shaded yellow) = 153 sqm  
Remainder Area (shaded grey) = 12470 sqm  
Total Site Area = ( 3.11 Acres)  
X 252956 Y 172856

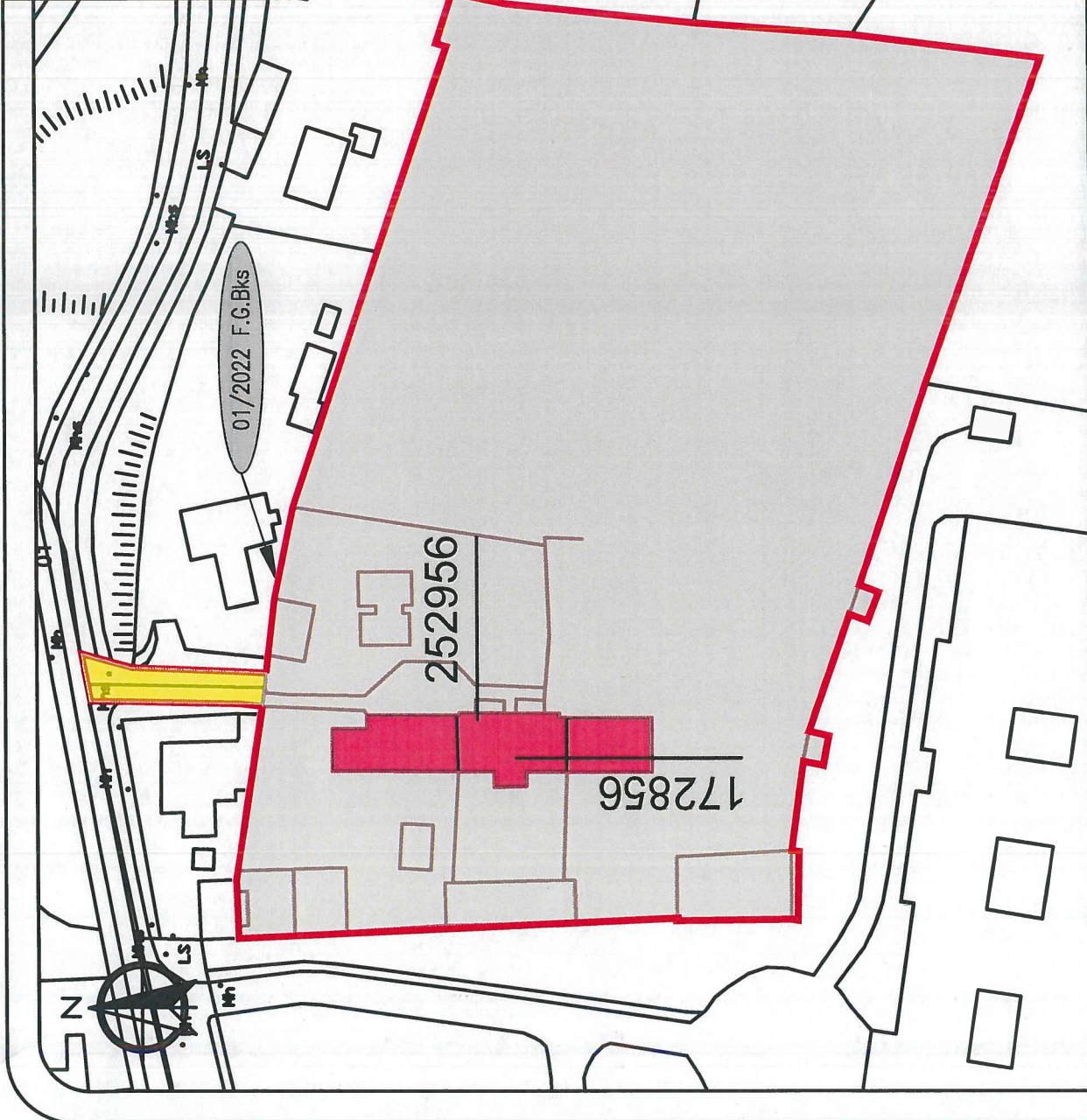

THE OFFICIAL SEAL OF  
THE HOUSING AUTHORITY  
WAS AFFIXED HERETO  
THIS 6<sup>th</sup> DAY OF Feb, 2022  
IN THE PRESENCE OF:

*Fidelis Doherty*  
*R. Man et al*

CATHAoirLEACH  
RUNAí CONTAe



DRAWN BY: PT	SCALE: 1:1,000 @ A4
CHECKED BY: PC / EC	DATE: 01/02/2022
FILE NO: 2022-CPO-01	DRAWING NO: 01/2022 F.G.Bks
ALL ORDNANCE SURVEY DATA BASED ON ORDNANCE SURVEY OF IRELAND MAP LICENCE NUMBER 2013 / 27 / CCMA / KILKENNY JOS Map Ref. 4410-17	

Drawing Title  
**Former Garda Barracks,  
Castlecomer, Co. Kilkenny  
Deposited Map 01 of 2022**

REV.	DESCRIPTION	DATE

Comhairle Chontae Chill Chainnigh  
Halla an Chontae Suid Binn Cill Chainnigh  
Kilkenny County Council  
County Hall John Street Kilkenny  
Tel: 056 7794000 Fax: 056 7794004  
E-mail: info@kilkennyco.ie  
Webpage: www.kilkennyco.ie  
Serving People - Preserving Heritage



© COPYRIGHT RESERVED