

**Mortar Survey Report**

**No. 06-09 Patrick Street Kilkenny**

**Wednesday 24th January 2024**



**LIMEWORX**

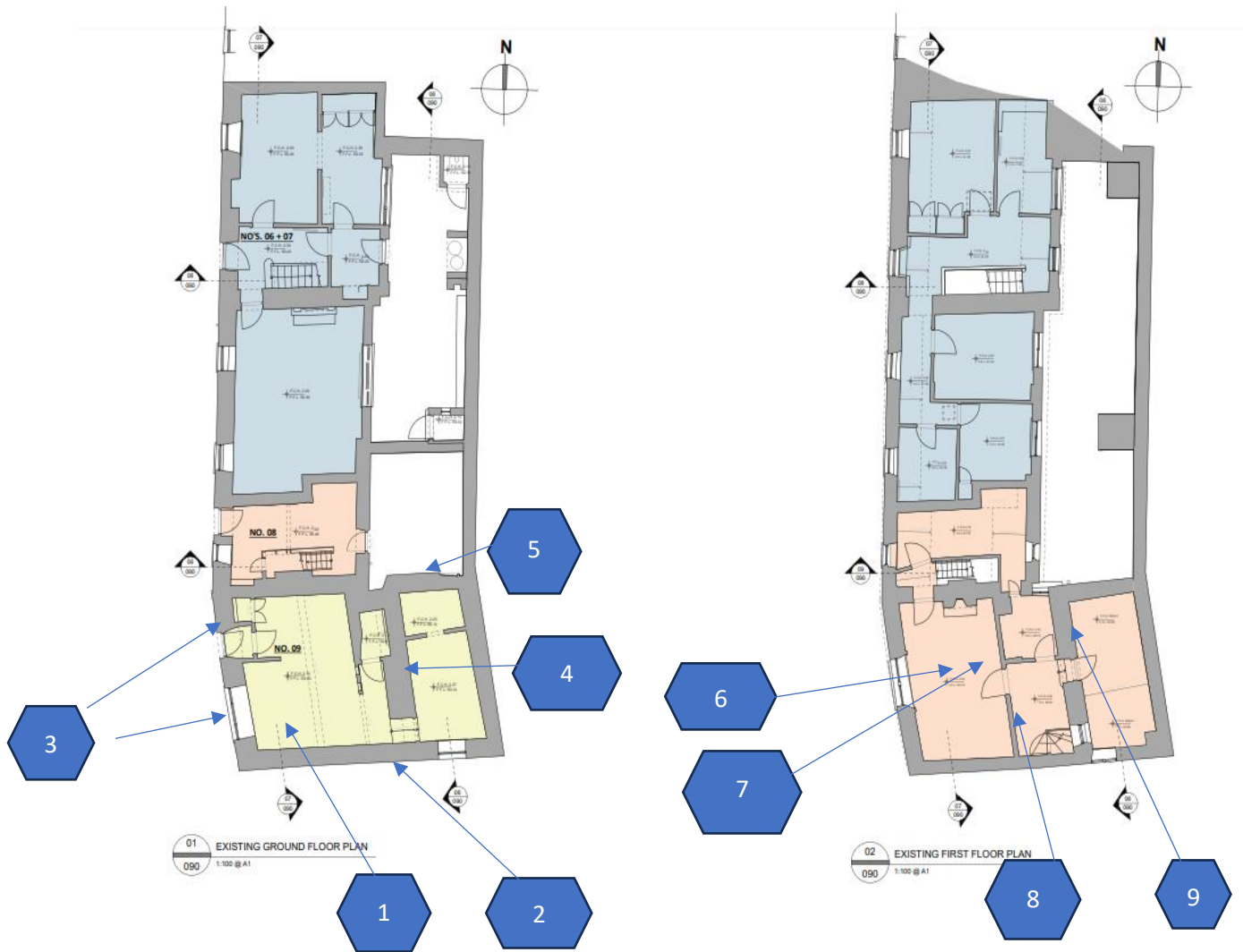

### House No9 GF

- 1- Original Fat lime joints 18<sup>th</sup> Century. Rendered over with modern cement dash finish.
- 2- Sample No1 taken from here.
- 3- Cement render removed, Timber lenth behind. Also, evidence of lime haired render with lime putty skim.
- 4- Timber stud wall with riven lath, originally lime putty plastered. Introduction of EML and rendered over in cement.
- 5- Natural stone wall outside 18<sup>th</sup> century with block infill.

### House No9 FF

- 6- Lime pargeting insulation in between floor joists, visible where joists were removed for inspection, to assume would have originally been on all FF.
- 7- Ceilings lath and lime putty skim, 18<sup>th</sup> century. Have been over boarded with gypsum.
- 8- Single leaf brick wall with lime plaster.
- 9- Lime plaster with animal hair present. This would have been and still is good practice in lime plastering for textile strength.



### House No8 GF.

- 1- Outside exterior wall stone granite and rubble nature
- 2- Window cill and window head of timber nature.
- 3- Timber panelling removed LHS wall in GF hallway to reveal concrete shutter works behind.

### House No8 FF.

- 4- All pitched ceilings are lath and lime plastering which have been crudely over boarded and skimmed with gypsum.
- 5- This wall is in the rear garden and is a 9-inch brick wall. With evidence of lime plastering.

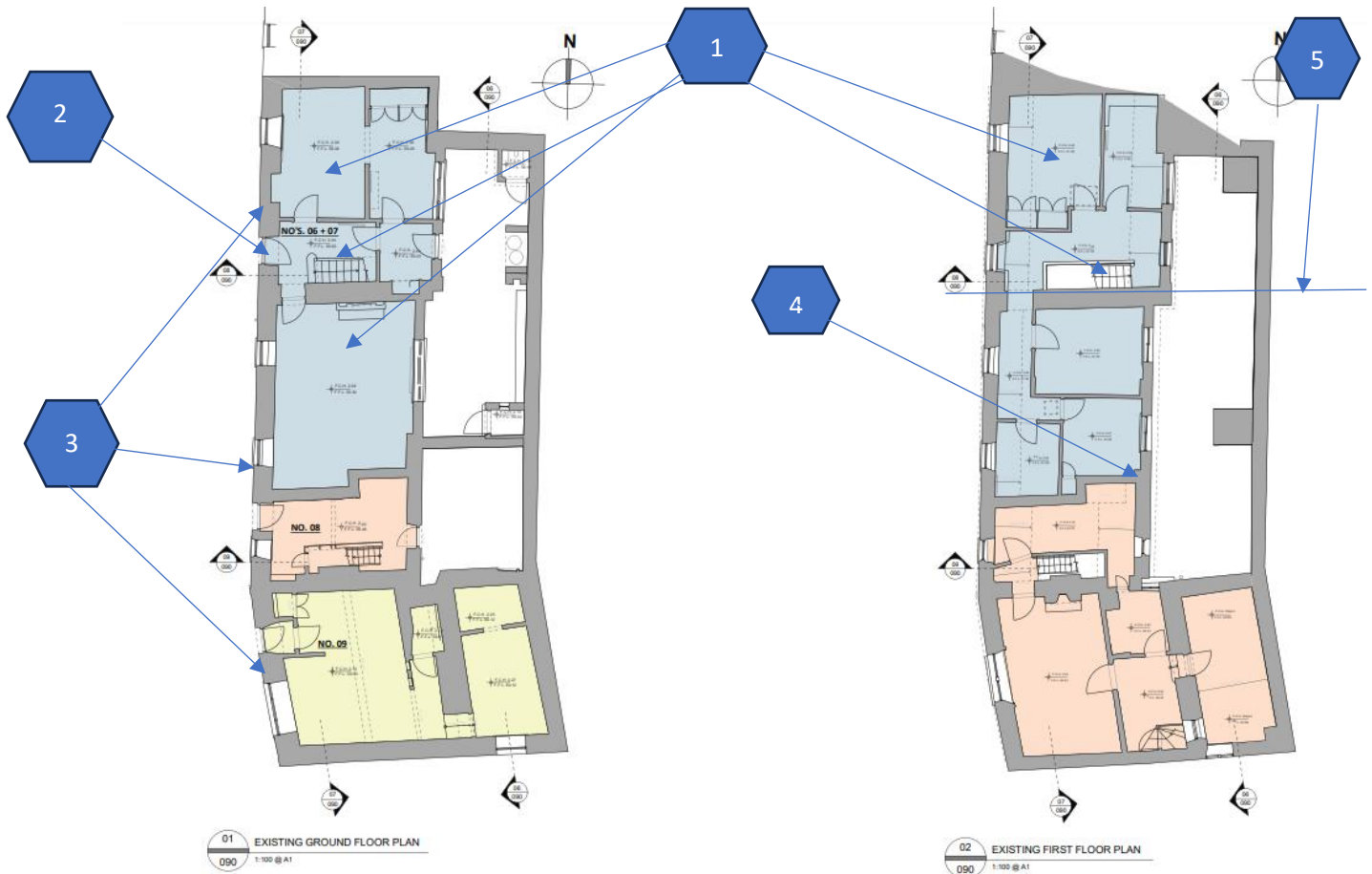

### Houses No6&7

- 1- Internally render is generally modern cement and gypsum skim over original lime renders walls.
- 2- Man made non original ope built with concrete block.
- 3- Generally full facades across houses 6-9 are cement rendered over stone rubble walls. When cement was removed fat lime was visible C. 18<sup>th</sup> Century.
- 4- Brick built wall with lime joints, plastered over in cement when exposed original wall plater was visible.
- 5- Stone rubble gable wall built with lime rendered over with cement C. 18<sup>th</sup> century.