

**SOUTH EAST GREENWAY - SOUTHERN CONNECTIVITY LINK -  
SLIEVERUE TO KILMURRAY LANE  
PUBLIC DISPLAY DRAWINGS  
(Part VIII Process)**



**Comhairle Chontae Chill Chainnigh**  
**Kilkenny County Council**

**ROADPLAN**  
CONSULTING

7 Ormonde Road,  
Kilkenny, R95 N4FE.  
Tel: +353(0)567795800  
E-mail: info@roadplan.ie



# SOUTH EAST GREENWAY - SOUTHERN CONNECTIVITY LINK - SLIEVERUE TO KILMURRAY LANE

## PUBLIC DISPLAY DRAWINGS (Part VIII Process)

DRAWING TITLE	DRAWING SERIES	DRAWING NUMBERS	REVISION NUMBER
COVER SHEET	DRAWING COVERSHEET	21006-01-0150	-
INDEX OF CONTENTS	DRAWING LIST	21006-01-0151	-
SITE LOCATION	LOCATION	21006-01-0152	-
OVERALL LAYOUT	PROPOSED LAYOUT	21006-01-0153	-
PROPOSED LAYOUT SHEET 1 of 4	PROPOSED LAYOUT	21006-01-0154	-
PROPOSED LAYOUT SHEET 2 of 4	PROPOSED LAYOUT	21006-01-0155	-
PROPOSED LAYOUT SHEET 3 of 4	PROPOSED LAYOUT	21006-01-0156	-
PROPOSED LAYOUT SHEET 4 of 4	PROPOSED LAYOUT	21006-01-0157	-
CROSS SECTIONS	CROSS SECTIONS	21006-01-0158	-



# Slieverue

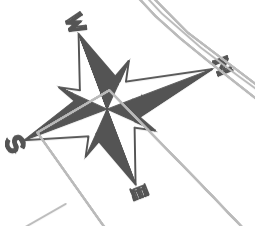
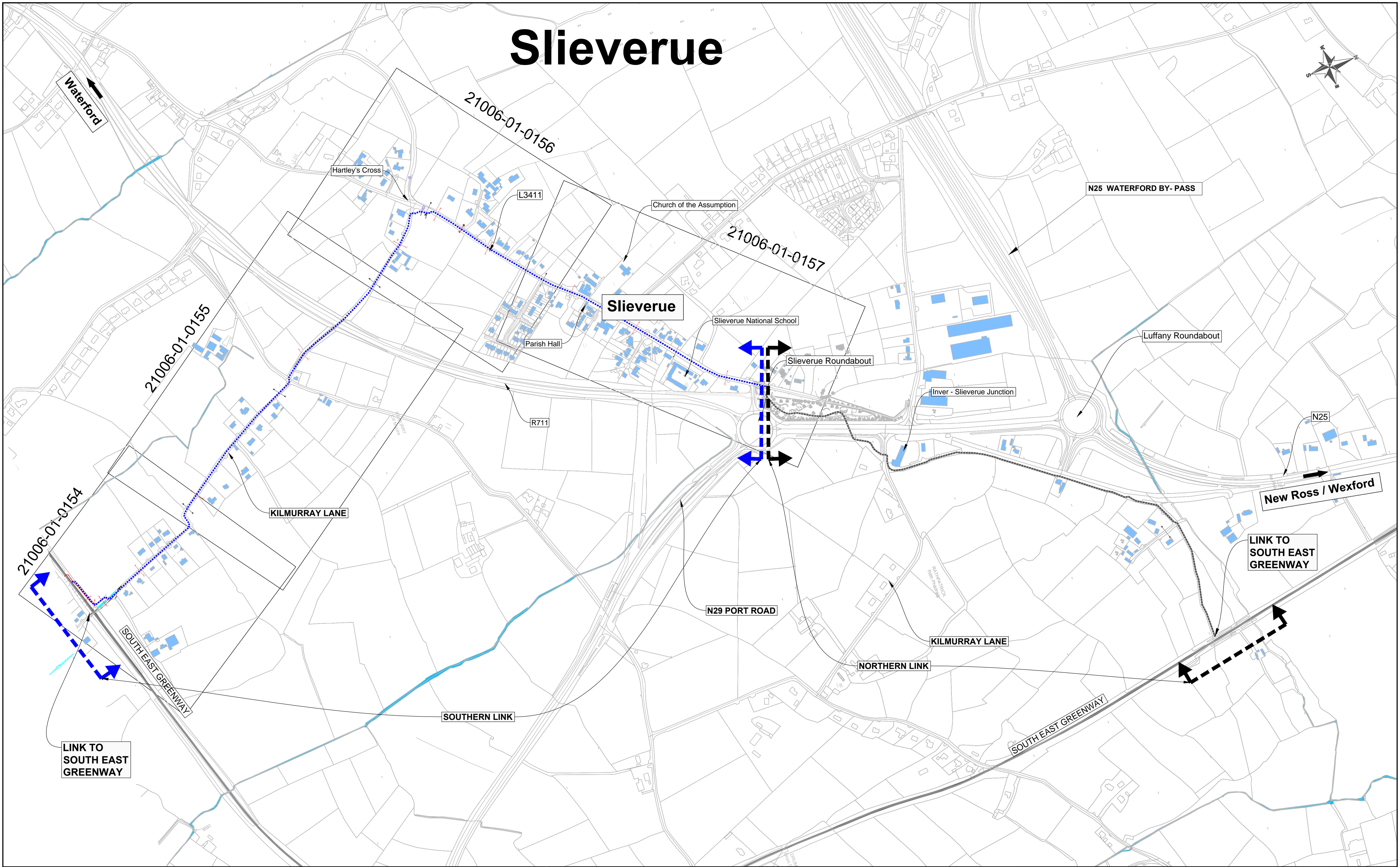

**NOTES**

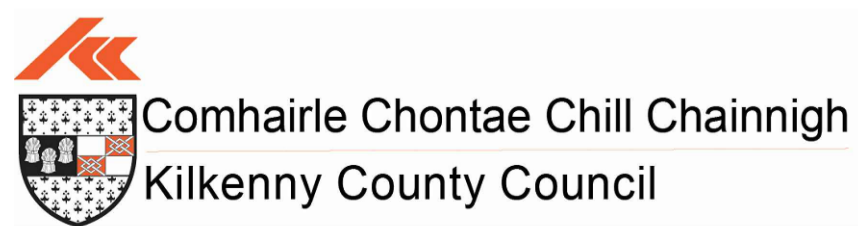

**ROADPLAN CONSULTING**  
 7 Ormonde Road,  
 Kilkenny, R95 N4FE,  
 Tel: +353(0)567795800  
 E-mail: info@roadplan.ie

No.	Revision	Date	By	Chk'd	App'd
Designed:	JB	Checked:	AC	Approved:	GF

Project Title:  
**SOUTH EAST GREENWAY - SOUTHERN CONNECTIVITY LINK - SLIEVERUE TO KILMURRAY LANE**

Drawing Title:  
**OVERALL LAYOUT**

Drawn by: JB    Sheet Size: A1    Scale: 1:4000    Date: Aug '24

Drawing Number: 21006-01-0153    Revision: -

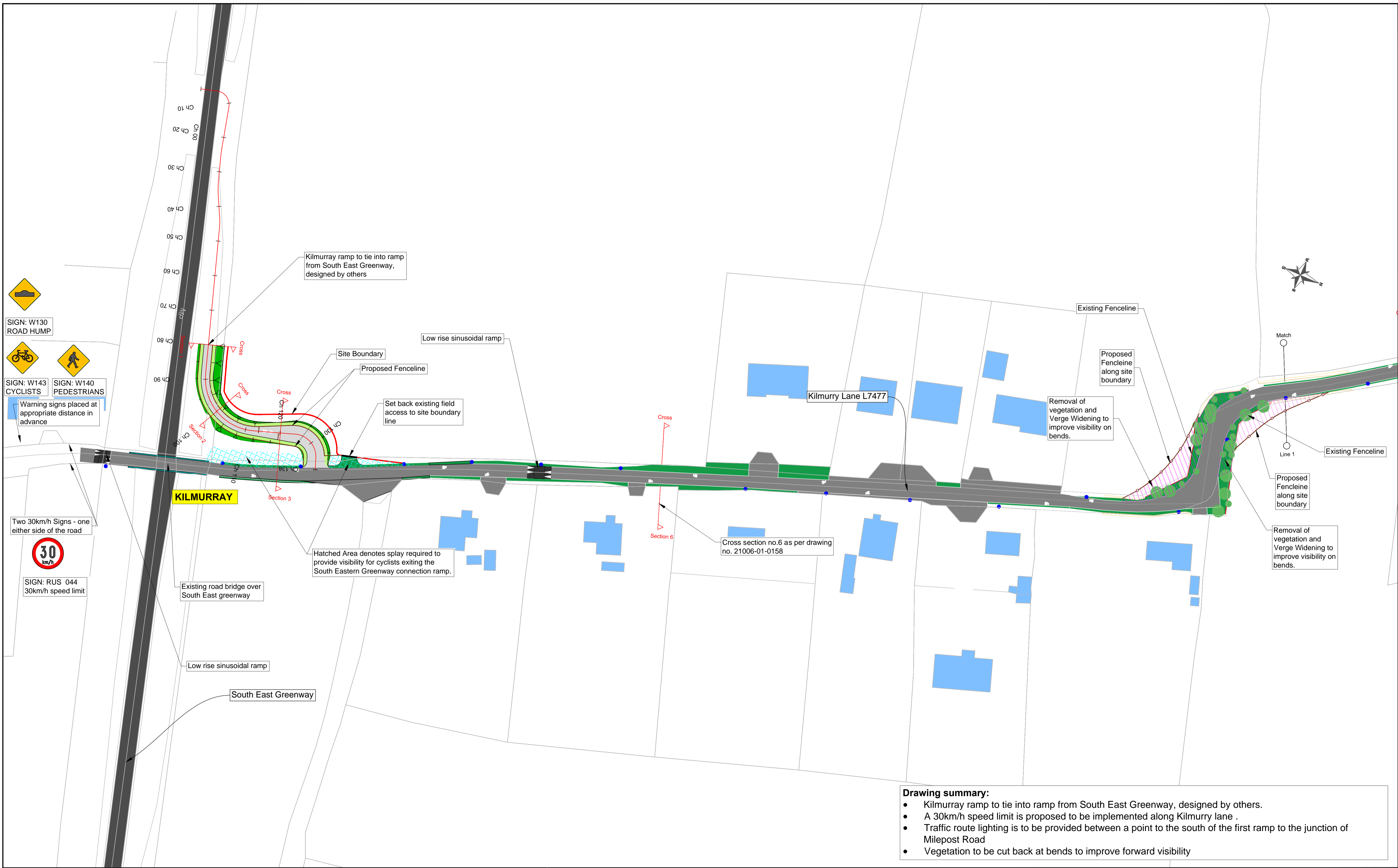

SIGN: W130 ROAD HUMPS

SIGN: W143 CYCLISTS

SIGN: W140 PEDESTRIANS

Warning signs placed at appropriate distance in advance

Two 30km/h Signs - one either side of the road

30 km/h

SIGN: RUS 044 30km/h speed limit

**Drawing summary:**

- Kilmurray ramp to tie into ramp from South East Greenway, designed by others.
- A 30km/h speed limit is proposed to be implemented along Kilmurray lane .
- Traffic route lighting is to be provided between a point to the south of the first ramp to the junction of Milepost Road
- Vegetation to be cut back at bends to improve forward visibility

7 Ormonde Road, Kilkenny, R95 N4FE. Tel: +353(0)567795800 E-mail: info@roadplan.ie

**LEGEND**

	Proposed Shared Pedestrian / Cyclist Surface		Grass / Landscaping / Hedgerow		Sinusoidal Ramp
	Proposed Shared Cyclist / Vehicle Surface		Existing Buildings		Public Lighting
	Carriageway / Private Access		Rest Area		Proposed Fenceline
	Proposed South East Greenway		Site Boundary		

Project Title: SOUTH EAST GREENWAY - SOUTHERN CONNECTIVITY LINK - SLIEVERUE TO KILMURRAY LANE					
Drawing Title: Proposed Layout (Sheet 1 of 4)					
Drawn by: JB	Sheet Size: A1	Scale: 1:500	Date: August '24		
Drawing Number: 21006-01-0154		Revision: -			
No.	Revision	Date	By	Chk'd	App'd
Designed: JB	Checked: AC	Approved: GF			

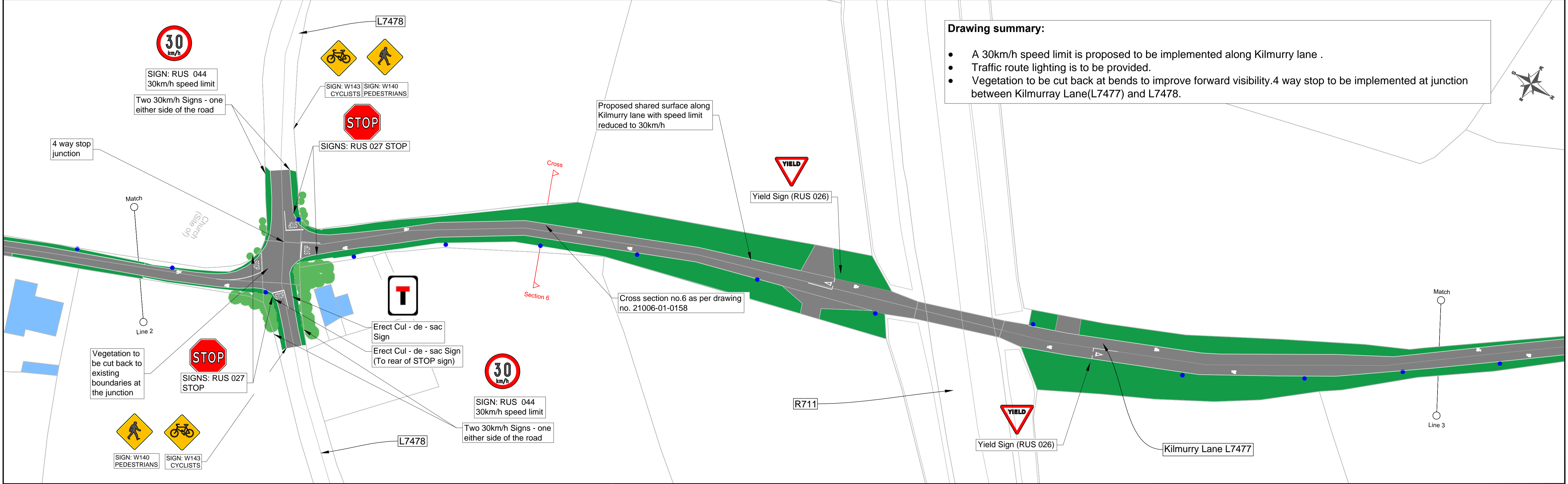

**Drawing summary:**

- A 30km/h speed limit is proposed to be implemented along Kilmurry lane .
- Traffic route lighting is to be provided.
- Vegetation to be cut back at bends to improve forward visibility. 4 way stop to be implemented at junction between Kilmurray Lane(L7477) and L7478.



Comhairle Chontae Chill Chainnigh  
Kilkenny County Council

7 Ormonde Road,  
Kilkenny, R95 N4FE.  
Tel: +353(0)567795800  
E-mail: info@roadplan.ie

**LEGEND**

	Proposed Shared Pedestrian / Cyclist Surface		Grass / Landscaping / Hedgerow		Sinusoidal Ramp
	Proposed Shared Cyclist / Vehicle Surface		Existing Buildings		Public Lighting
	Carriageway / Private Access		Rest Area		Proposed Fenceline
	Proposed South East Greenway		Site Boundary		

No.	Revision	Date	By	Chk'd	App'd

Designed: JB	Checked: AC	Approved: GF
--------------	-------------	--------------

Project Title:  
**SOUTH EAST GREENWAY - SOUTHERN CONNECTIVITY LINK - SLIEVERUE TO KILMURRAY LANE**

Drawing Title:  
**Proposed Layout (Sheet 2 of 4)**

Drawn by: JB	Sheet Size: A1	Scale: 1:500	Date: Aug '24
Drawing Number: 21006-01-0155		Revision: -	

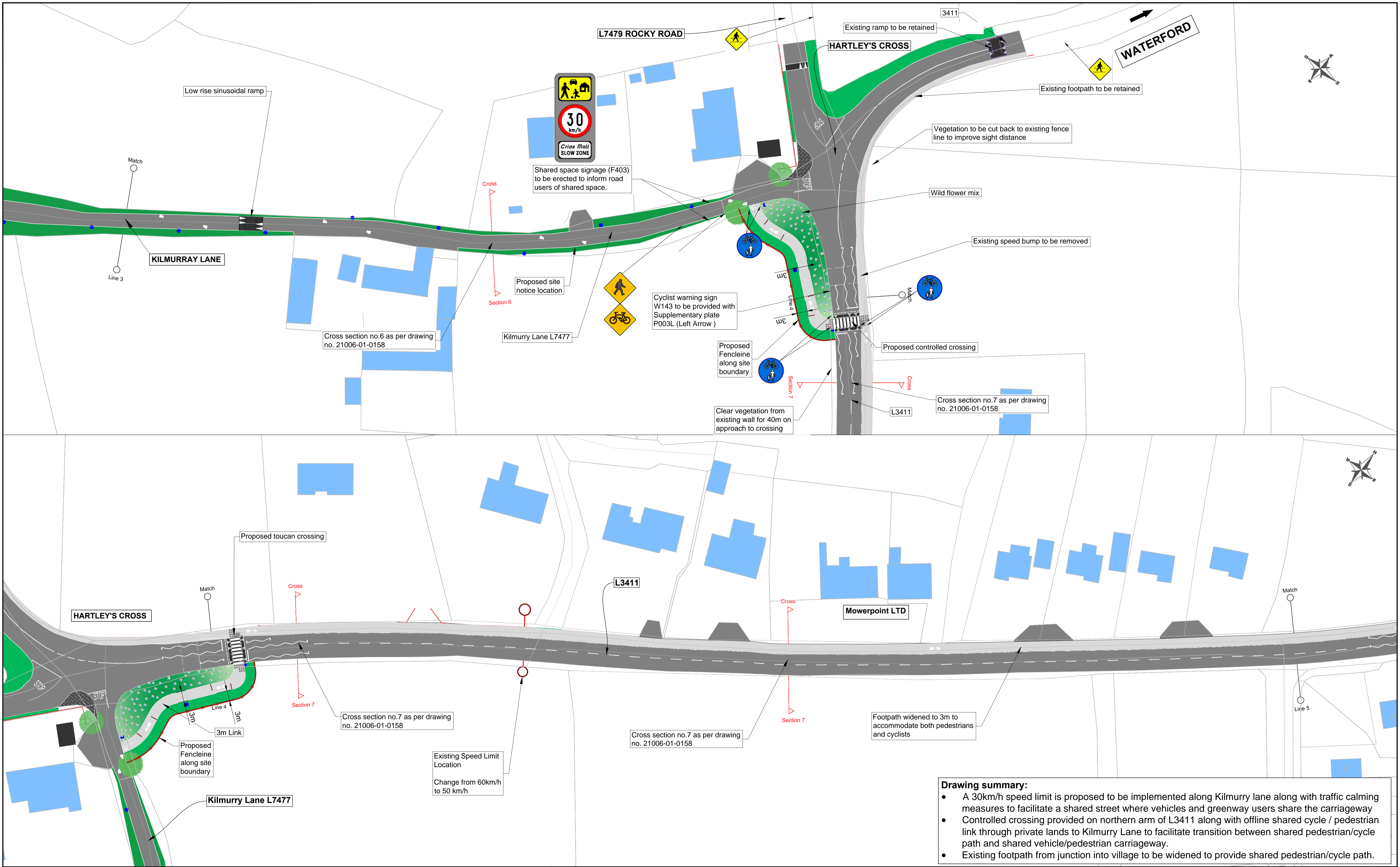

**Drawing summary:**

- A 30km/h speed limit is proposed to be implemented along Kilmurry lane along with traffic calming measures to facilitate a shared street where vehicles and greenway users share the carriageway
- Controlled crossing provided on northern arm of L3411 along with offline shared cycle / pedestrian link through private lands to Kilmurry Lane to facilitate transition between shared pedestrian/cycle path and shared vehicle/pedestrian carriageway.
- Existing footpath from junction into village to be widened to provide shared pedestrian/cycle path.

Comhairle Chontae Chill Chainnigh  
Kilkenny County Council

7 Ormonde Road,  
Kilkenny, R95 N4FE.  
Tel: +353(0)567795800  
E-mail: info@roadplan.ie

**LEGEND**

Proposed Shared Pedestrian / Cyclist Surface	Grass / Landscaping / Hedgerow	Sinusoidal Ramp
Proposed Shared Cyclist / Vehicle Surface	Existing Buildings	Public Lighting
Carriageway / Private Access	Rest Area	Proposed Fenceline
Proposed South East Greenway		Site Boundary

No.	Revision	Date	By	Chk'd	App'd

Designed: JB	Checked: AC	Approved: GF
--------------	-------------	--------------

Project Title:  
**SOUTH EAST GREENWAY - SOUTHERN CONNECTIVITY LINK - SLIEVERUE TO KILMURRAY LANE**

Drawing Title:  
**Proposed Layout (Sheet 3 of 4)**

Drawn by: JB	Sheet Size: A1	Scale: 1:500	Date: Aug '24
Drawing Number: 21006-01-0156		Revision: -	

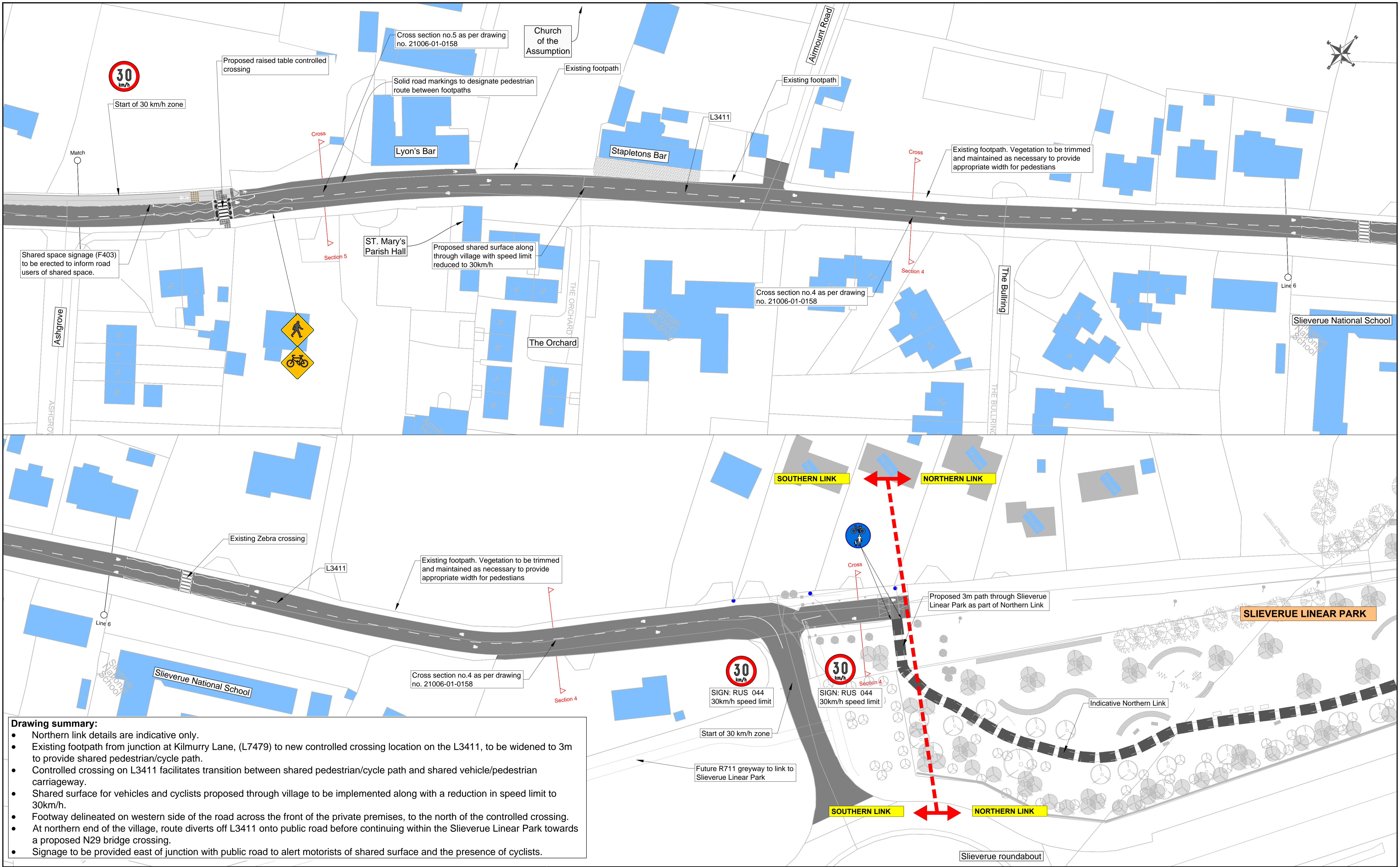

**Drawing summary:**

- Northern link details are indicative only.
- Existing footpath from junction at Kilmurry Lane, (L7479) to new controlled crossing location on the L3411, to be widened to 3m to provide shared pedestrian/cycle path.
- Controlled crossing on L3411 facilitates transition between shared pedestrian/cycle path and shared vehicle/pedestrian carriageway.
- Shared surface for vehicles and cyclists proposed through village to be implemented along with a reduction in speed limit to 30km/h.
- Footway delineated on western side of the road across the front of the private premises, to the north of the controlled crossing.
- At northern end of the village, route diverts off L3411 onto public road before continuing within the Slieverue Linear Park towards a proposed N29 bridge crossing.
- Signage to be provided east of junction with public road to alert motorists of shared surface and the presence of cyclists.

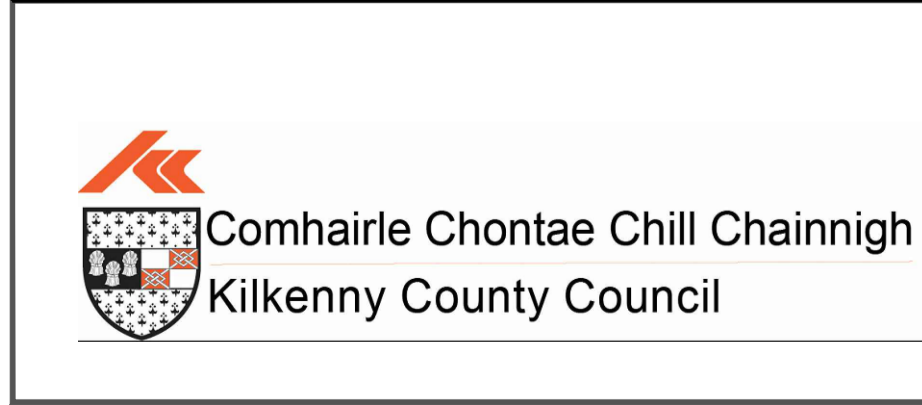

**ROADPLAN CONSULTING**  
 7 Ormonde Road, Kilkenny, R95 N4FE.  
 Tel: +353(0)567795800  
 E-mail: info@roadplan.ie

**LEGEND**

Proposed Shared Pedestrian / Cyclist Surface	Grass / Landscaping / Hedgerow	Sinusoidal Ramp
Proposed Shared Cyclist / Vehicle Surface	Existing Buildings	Public Lighting
Carriageway / Private Access	Rest Area	Proposed Fencing
Proposed South East Greenway		Site Boundary

No.	Revision	Date	By	Chk'd	App'd

Project Title: **SOUTH EAST GREENWAY - SOUTHERN CONNECTIVITY LINK - SLIEVERUE TO KILMURRAY LANE**

Drawing Title: **Proposed Layout (Sheet 4 of 4)**

Drawn by: JB	Sheet Size: A1	Scale: 1:500	Date: Aug '24
Design: JB	Checked: AC	Approved: GF	Revision: -

Drawing Number: 21006-01-0157



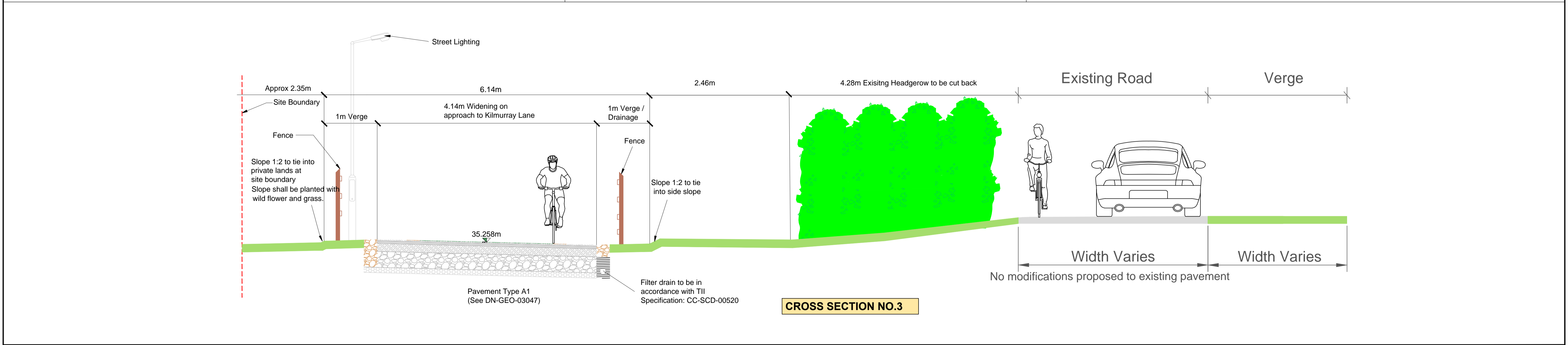
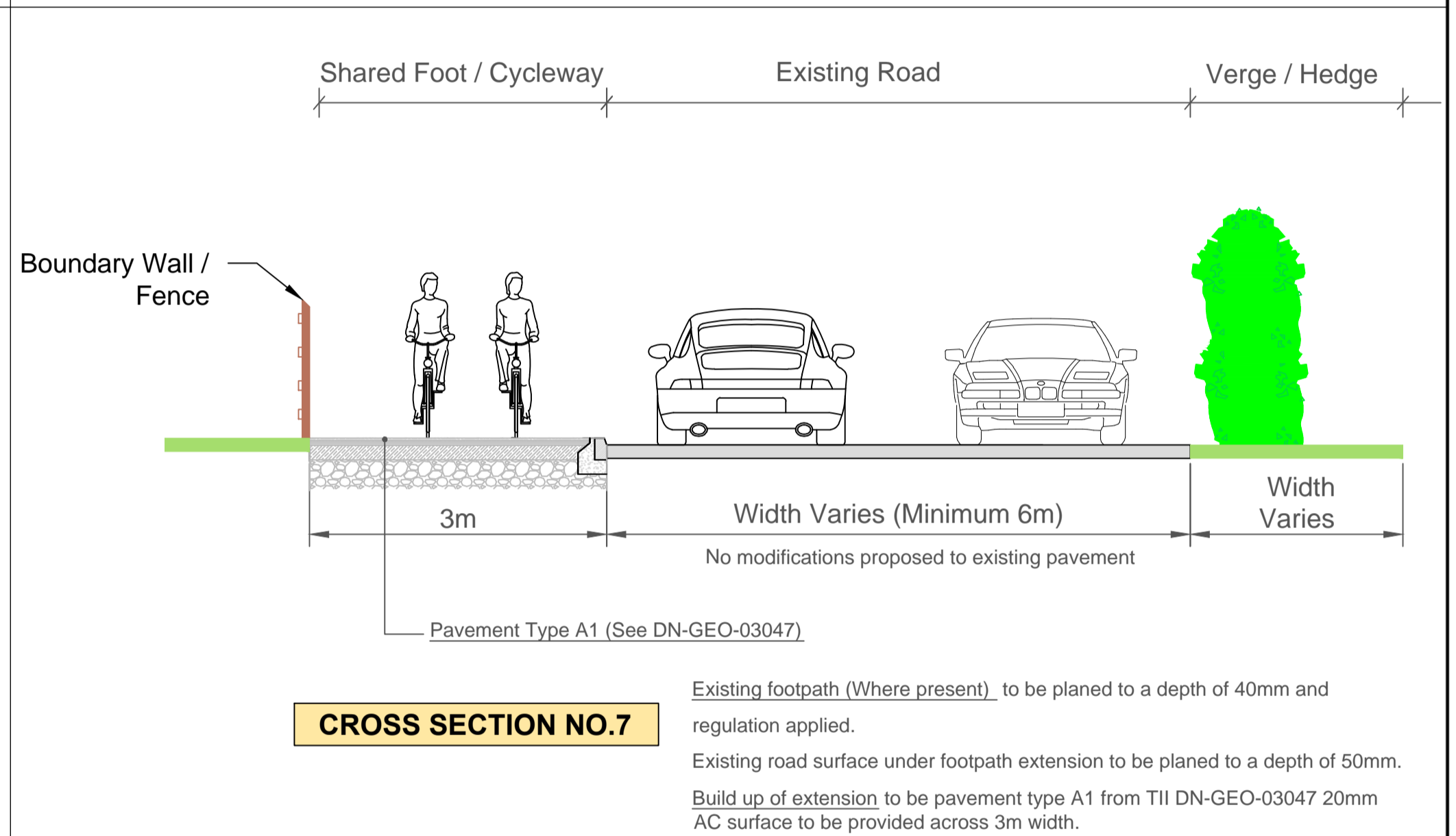
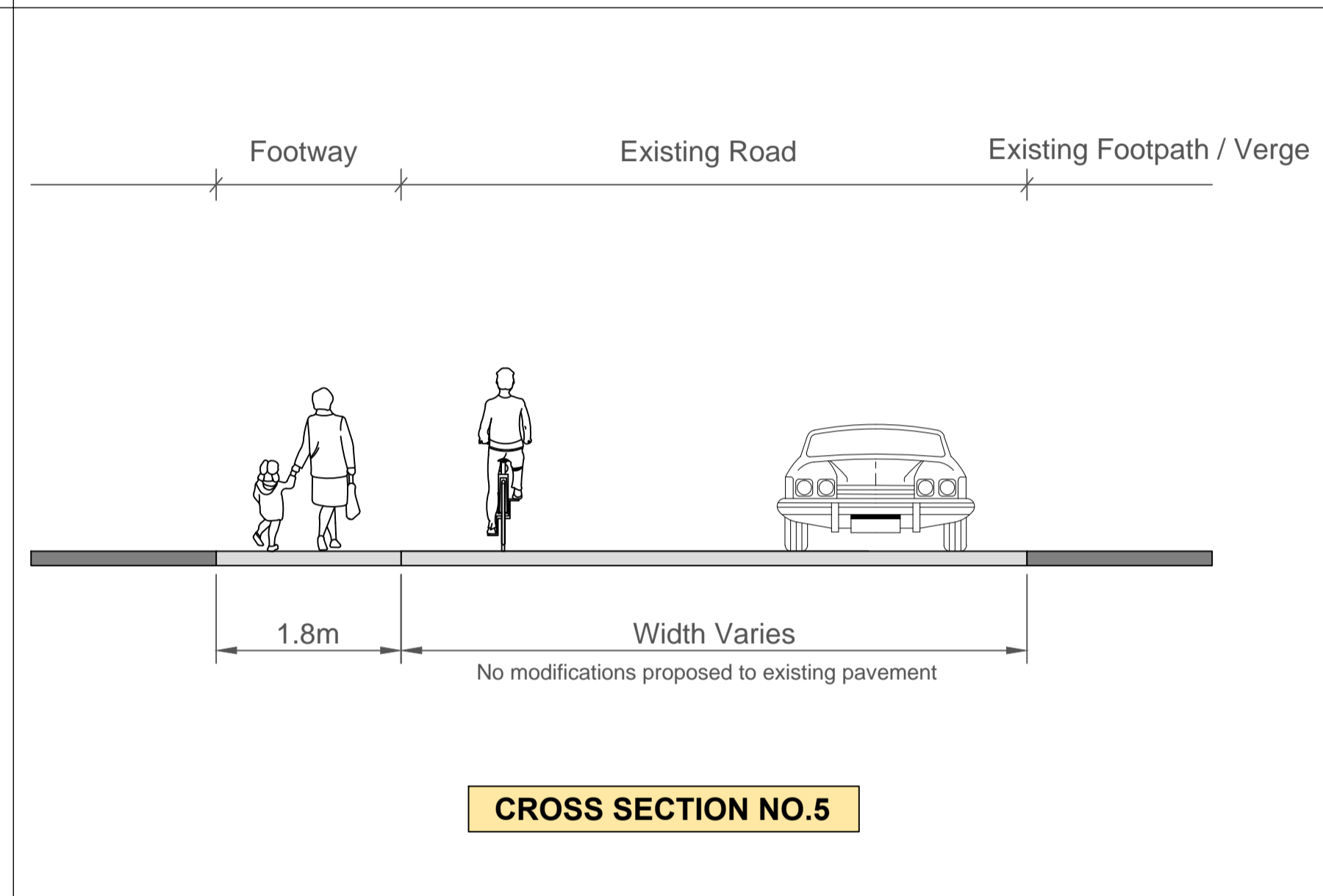
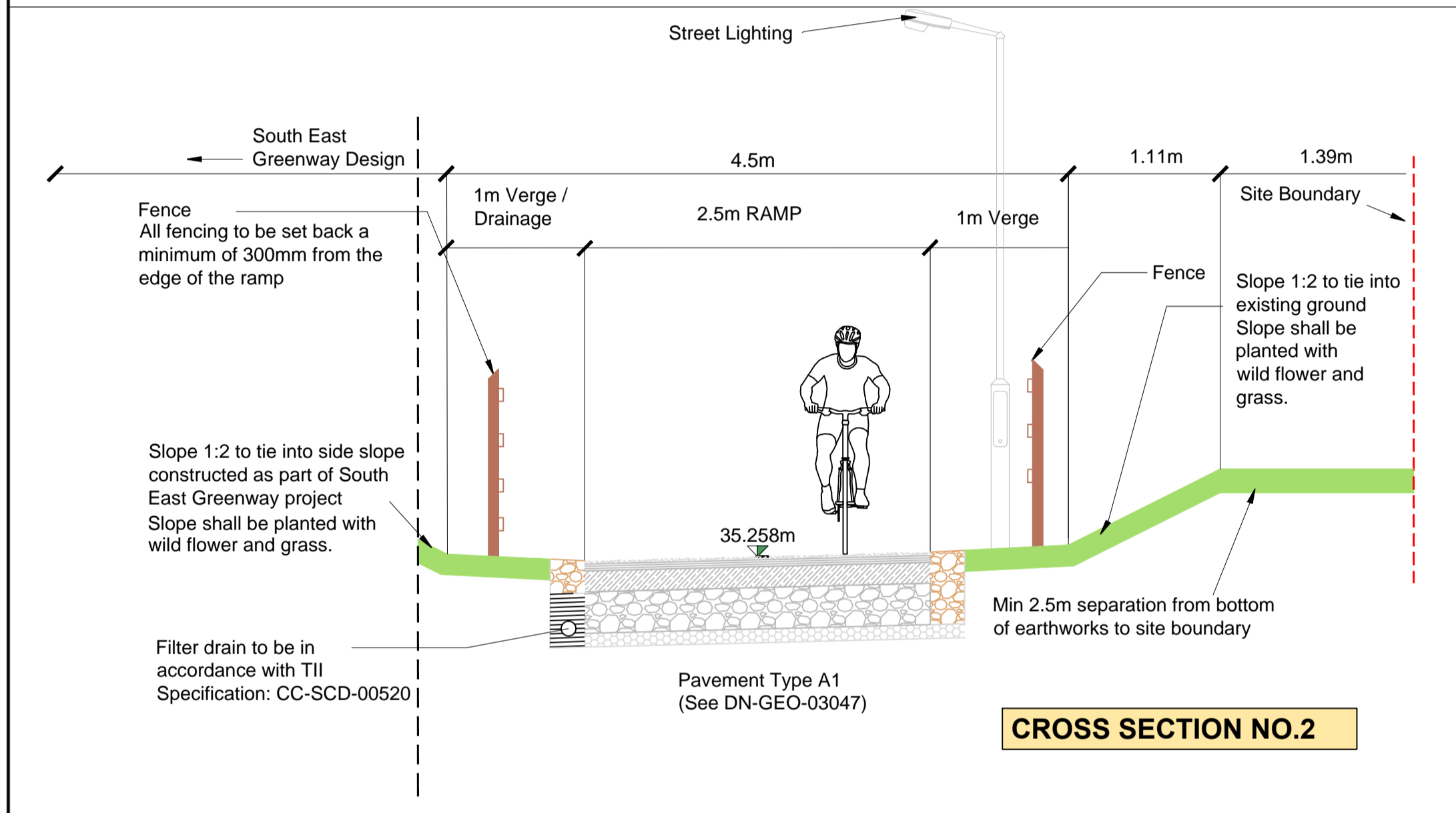
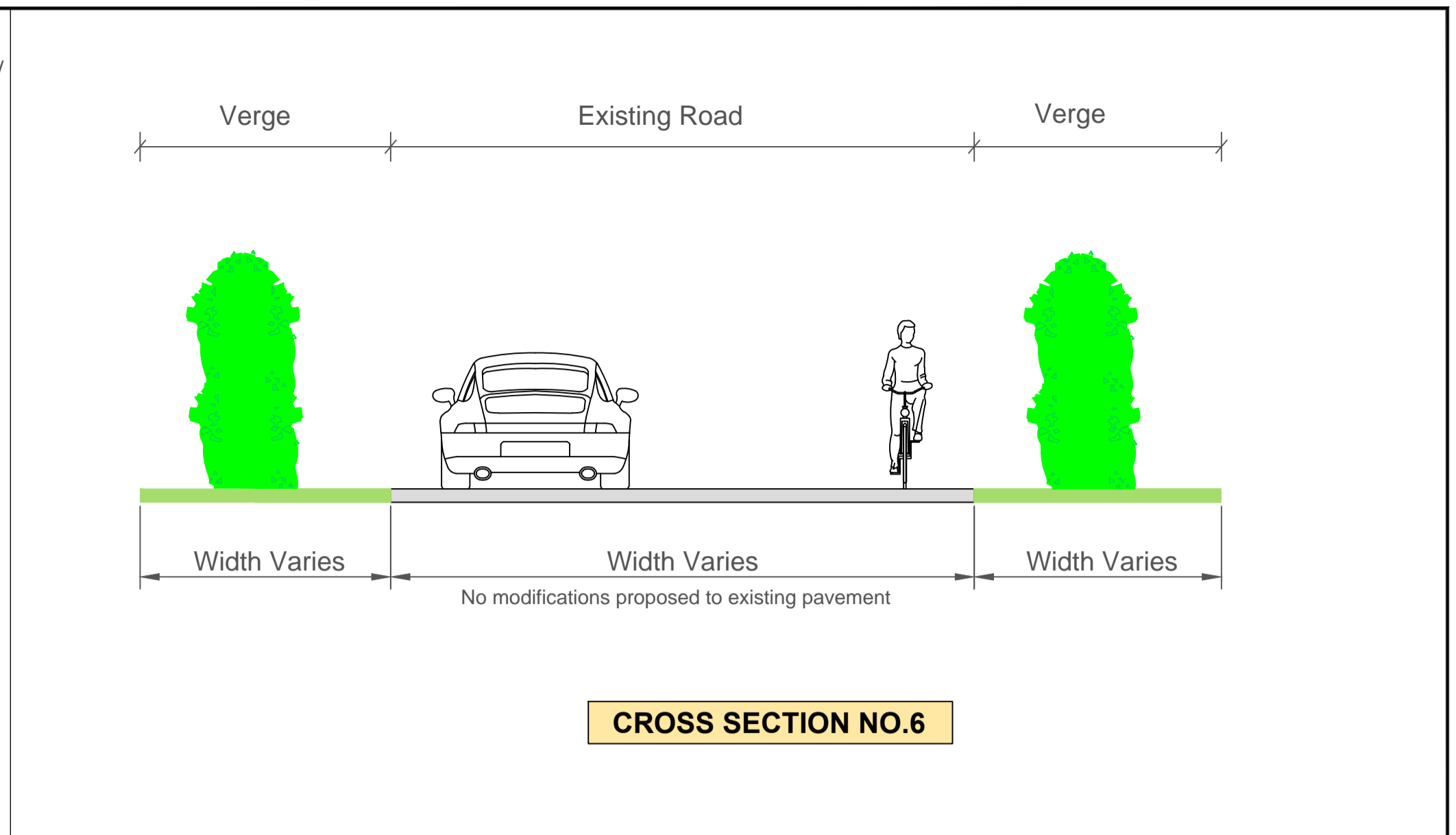
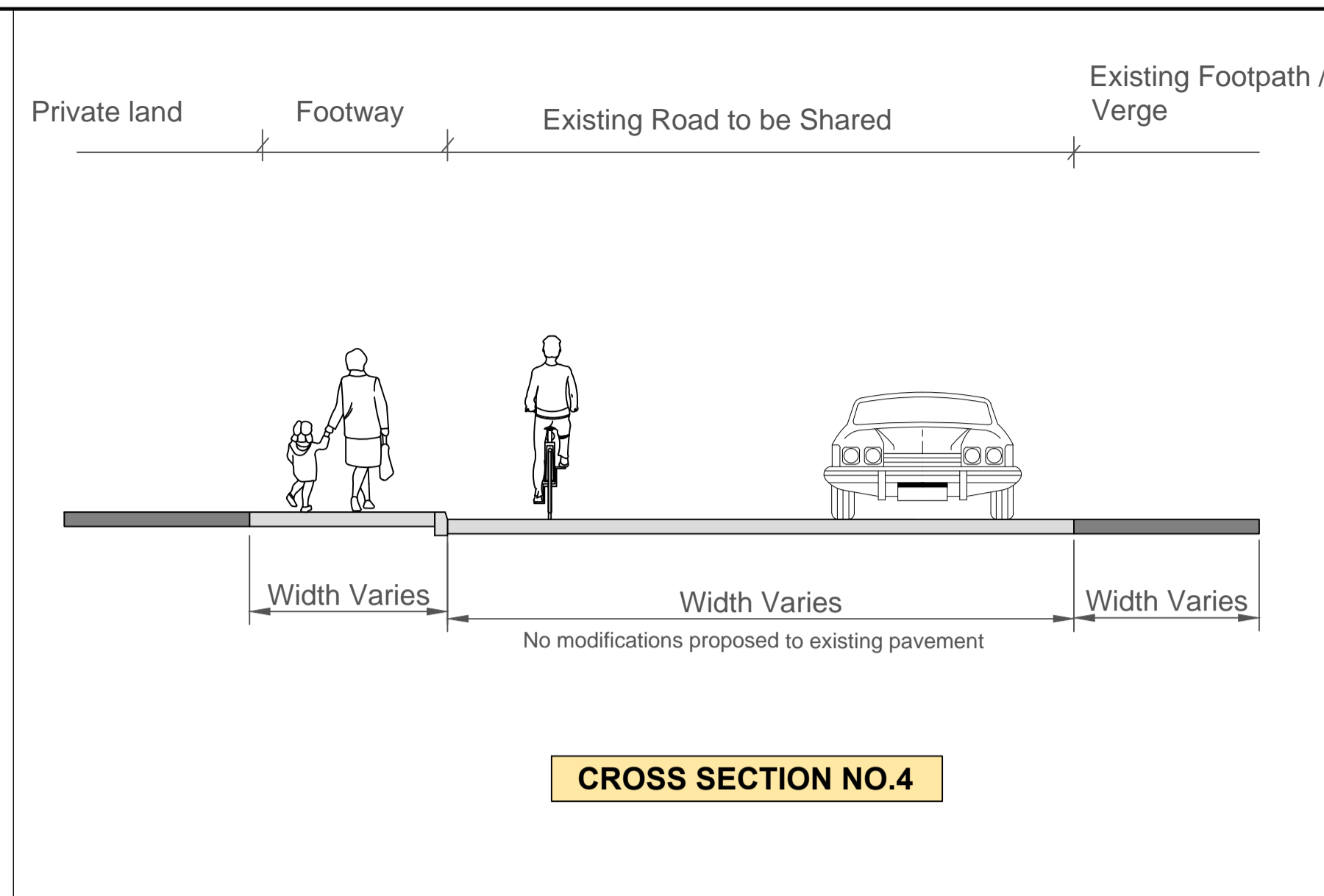
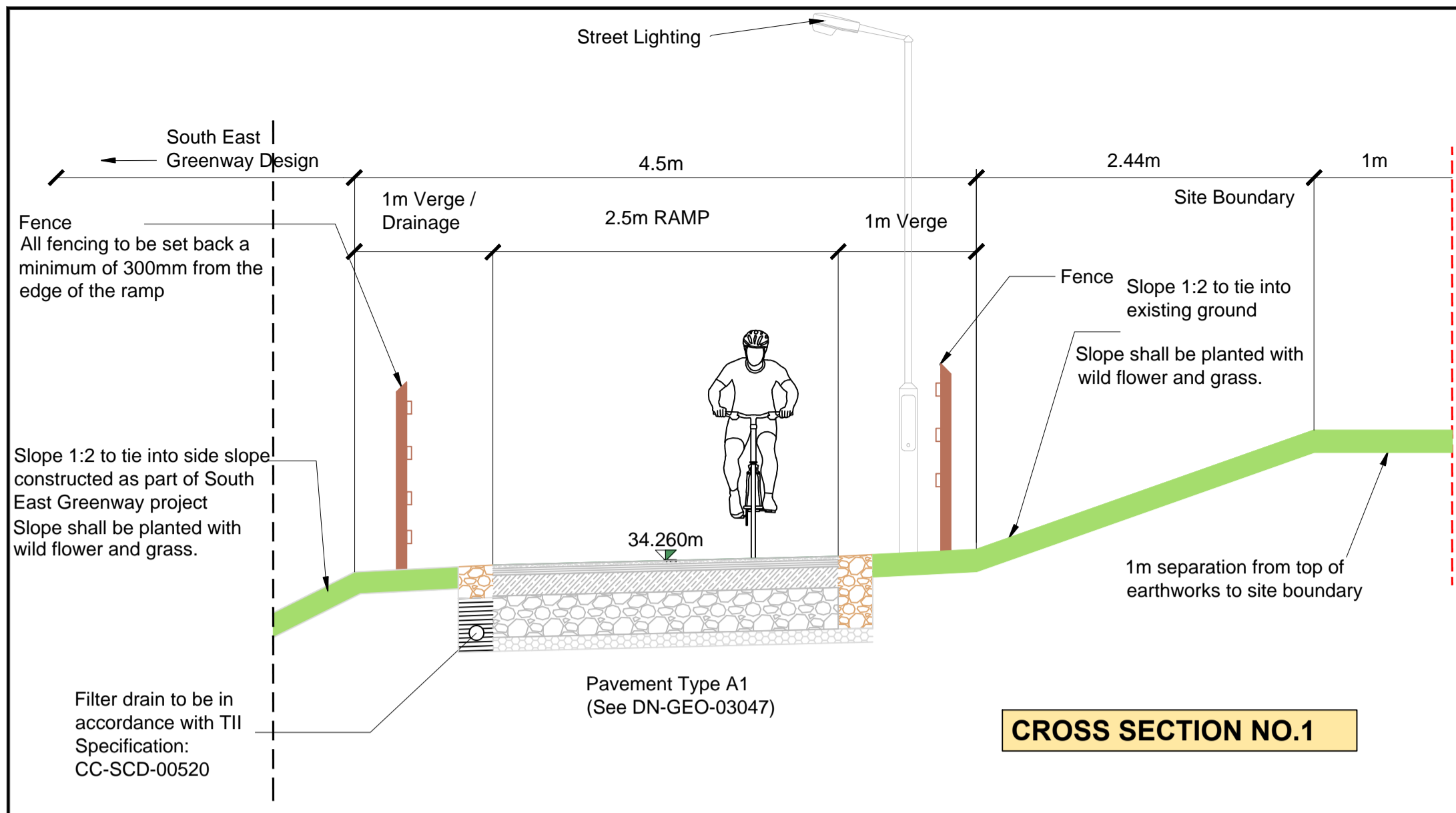

**Notes:**

7 Ormonde Road, Kilkenny, R95 N4FE. Tel: +353(0)567795800 E-mail: info@roadplan.ie

Project Title: <b>SOUTH EAST GREENWAY - SOUTHERN CONNECTIVITY LINK - SLIEVERUE TO KILMURRAY LANE</b>				
Drawing Title: <b>Cross Sections</b>				
Drawn by: JB	Sheet Size: A1	Scale: NTS	Date: Aug '24	
Drawing Number: 21006-01-0158				
Revision: -				
No.	Revision	Date	By	Chk'd App'd
Designed: JB	Checked: AC	Approved: GF		