

1. THE SPECIFICATION OF THE WORKS SHALL BE AS PER THAT OF THE WATERFORD TO NEW ROSS GREENWAY.
2. DETAILS SHOWN ARE FOR PLANNING PURPOSES AND ALL DETAILS AND BOUNDARY TREATMENTS SHALL BE AGREED IN CONSULTATION WITH THE AFFECTED PARTIES AND LANDOWNERS.

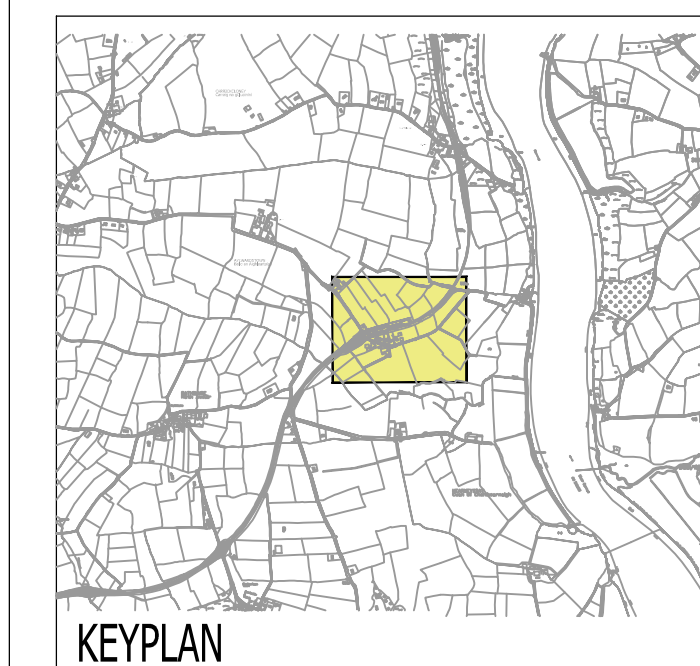

KEYPLAN

OS MAP REF:
 5441-D, 5442-C, 5502-B, 5503 (SCALE 1:2500)
 ITM CENTREPOINT CO-ORDINATE 66705E, 621045N
 REPRODUCED UNDER OS LICENCE NO. EN 0009617

THIS DRAWING IS COPYRIGHT OF KILGALLEN AND PARTNERS AND ISSUED UNDER LICENCE

PL1	10.1.18	KS	ISSUED FOR PLANNING - PART 8
ISS	DATE	BY	DETAILS



DESIGN
CIVIL ENGINEERING

STATUS
PLANNING - PART 8

CLIENT
KILKENNY COUNTY COUNCIL

PROJECT
WATERFORD TO NEW ROSS GREENWAY

TITLE
PROPOSED GENERAL LAYOUT OF GREENWAY AT AYLRWARDSTOWN CH11+930m TO CH12+500m (SHEET 2 OF 2)



DRN: KS	SCALE: 1:250 @ A1 NTS @ A3	DRAWING NO.:	ISSUE:
CHKD: NoC	DATE: 10/JAN/18	17006-103	PL1



WATERFORD TO NEW ROSS GREENWAY
 (CHAINAGE 12.26km TO 12.4km)

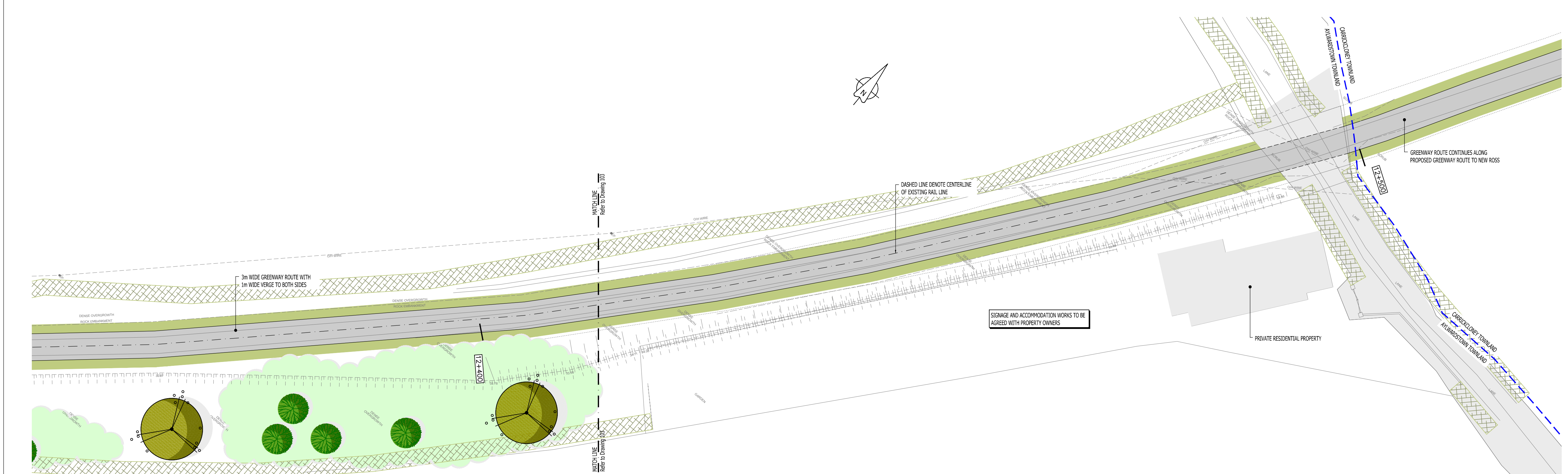

WATERFORD TO NEW ROSS GREENWAY
 (CHAINAGE 12.4km TO 12.5km)