

Rev.	By	Date	Description
A	CS		

BLOCK F

TYPE D1.1

REF: F-01 5 Bed 9 Person House units

Quality Housing for Sustainable Communities space provision						
	Dwelling Type	Gross Floor Area	Minimum Main Living Room	Aggregate living area	Aggregate bedroom area	Storage
Target	5 Bed/9 Person	120	15	40	43	6
Proposed	5 Bed/9 Person	152.0	15.4	40.4	46.2	8.4

PLEASE NOTE:
Minimum unobstructed living room width 3.8m.
Main bedroom area 13m², Double room 11.4m² (2.8m minimum width)

TYPE C1.1

REFS: F02-F03-F04 4 Bed 7 Person House units

Quality Housing for Sustainable Communities space provision						
	Dwelling Type	Gross Floor Area	Minimum Main Living Room	Aggregate living area	Aggregate bedroom area	Storage
Target	4 Bed/7 Person	120	15	40	43	6
Proposed	4 Bed/7 Person	126.0	15.4	40.4	46.2	6.7

PLEASE NOTE:
Minimum unobstructed living room width 3.8m.
Main bedroom area 13m², Double room 11.4m² (2.8m minimum width)

TYPE B1.1

REFS: F05-F06 3 Bed 5 Person House units

Quality Housing for Sustainable Communities space provision						
	Dwelling Type	Gross Floor Area	Minimum Main Living Room	Aggregate living area	Aggregate bedroom area	Storage
Target	3 Bed/5 Person	92	13	34	32	5
Proposed	3 Bed/5 Person	107.5	15.4	35.3	32.5	6.1

PLEASE NOTE:
Minimum unobstructed living room width 3.8m.
Main bedroom area 13m², Double room 11.4m² (2.8m minimum width)

TYPE C2.2

REFS: F07 4 Bed 7 Person House units

Quality Housing for Sustainable Communities space provision						
	Dwelling Type	Gross Floor Area	Minimum Main Living Room	Aggregate living area	Aggregate bedroom area	Storage
Target	3 Bed/5 Person	110	15	40	43	6
Proposed	3 Bed/5 Person	129.0	15.4	40.4	46.1	6.7

PLEASE NOTE:
Minimum unobstructed living room width 3.8m.
Main bedroom area 13m², Double room 11.4m² (2.8m minimum width)

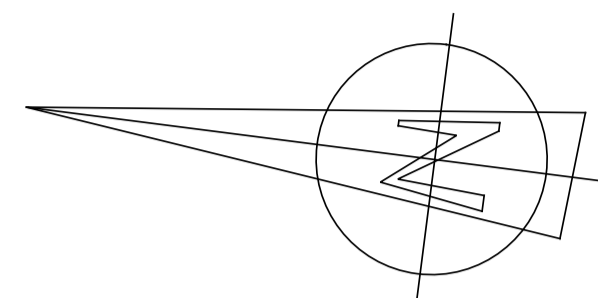

4 Bed 7 Person House units	4 no
3 Bed 5 Person House units	2 no
5 Bed 9 Person House units	1 no
Total units BLOCK F	7 no

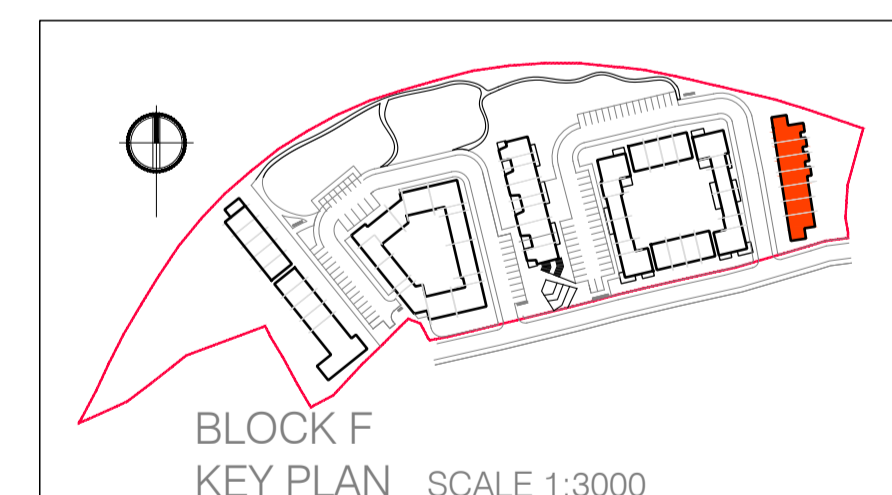

BLOCK F
Ground Floor Plan
Scale 1:100

CPR Note:
All works to be carried out using proper materials which are fit for the use they are intended and for the condition in which they are to be used.
All materials used in connection with the works to comply with the Construction Products Regulation (EU) No. 305/2011 and the harmonised technical specifications/standards that fall within the remit of the CPR No. 305/2011

van Dijk Architects
MILL HOUSE, MILL STREET, DUNDALK, CO. LOUTH
PH: 01274354466 FAX: 01274354466
INFO@VANDIJKARCHITECTS.COM

DRAWING TITLE			
BLOCK F GROUND FLOOR PLAN PLANNING ISSUE			
SCALE	1:100	CLIENT	1803-PA-BLF-100
PROJECT	AI	DATE	05.07.2019
DESIGNED BY	VP	DATE	05.07.2019

NOTE:
FIGURED DIMENSIONS MUST BE USED IN PREFERENCE TO STATED DIMENSIONS. ANY DIMENSIONAL DISCREPANCIES MUST BE REPORTED TO THE ARCHITECT IMMEDIATELY. THIS DRAWING REMAINS THE COPYRIGHT OF VAN DIJK ARCHITECTS. IT MUST NOT BE USED FOR ANY PURPOSES OUTSIDE OF THE EXPRESS PERMISSION OF THE ARCHITECT. DO NOT COPY OR REDISTRIBUTE THESE DRAWINGS OR ANY ADDITIONAL INFORMATION WITHOUT THE EXPRESS APPROVAL OF van Dijk Architects